

# Technical Sheet STUDIO 1

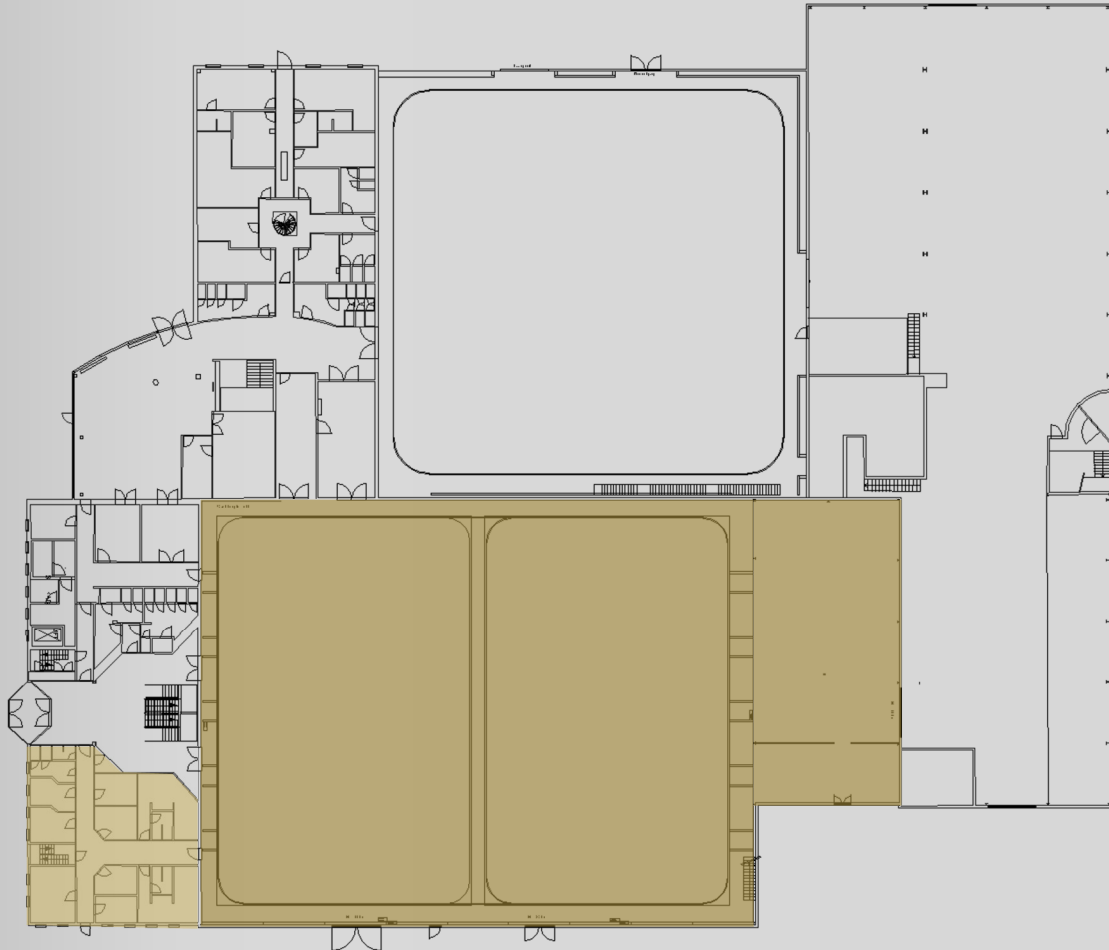

## STUDIO FLOOR :

- Total floor area: 45,20m (L) x 34,60m (W) = 1564m<sup>2</sup>
  - Free floor area: 42,30m (L) x 31,70m (W) = 1341m<sup>2</sup> (inside cyclo)
  - Height under catwalks: 7,70m
  - Height under grid: 7,95m (max. height)
  - Rigging beams: 9,80m
  - Studio can be divided in 2 areas
- Floor type:
- Polybeton (Epoxy)

## GRID:

- 3 grid frame with dimensions 19m x 9,60m
- 3 grid frame with dimensions 18m x 9,60m
- Each grid frame is equipped with 7 Harting 16 plugs with 5 channels, connected with Harting connectors in the dimmer room.

## POWER SUPPLY:

- Total of 600 kVA/ 3 x 380 + N, subdivided into:  
*Number - Amperes/phase - Connector - Location*
- 1 x 250 A Powerlock Studio
  - 1 x 125 A CEE Studio
  - 1 x 63 A CEE Studio
  - 2 x 4 32 A (25A) CEE Studio
  - 4 x 250 A Powerlock Dimmer Room

## ACCESS :

- Emergency doors:
- 1 x 2,31m (W) Double emergency doors
  - 1 x 1,92m (W) Double emergency doors
  - 1 x 0,90m (W) Single emergency doors
- Studio access:
- From storage to studio: 4 m (W) x 4,78 m (H)
  - From street to studio: 4 m (W) x 4,78 m (H)
  - From Studio to dressing rooms: 0,89 m (W) x 1,98m (H)
  - Loading platform height relative to ground: 0 m

## CURTAINS :

- Black: covers the entire studio
  - Neutral light grey cyclorama: 60m
  - Bluekey: 60m
- the cyclorama system has 3 possible circuits on rails:
- the entire studio
  - half the studio on the left
  - half the studio on the right
- All curtains are fireproof

## BUILDING FACILITIES :

- Dressing rooms: 6 units (Average area 8 m<sup>2</sup>)
  - Mirror
  - Dresser
  - Chair
- Luxury dressing rooms : 2 units (20 m<sup>2</sup> + 5 m<sup>2</sup>)
  - Mirror
  - Dresser
  - Chair
  - Shower + washbasin
- Make-up room: 17 m<sup>2</sup>
  - Mirrors with lighting
  - Work surface
  - Washbasin with hot and cold water
- Production room