

Technical Sheet STUDIO 1

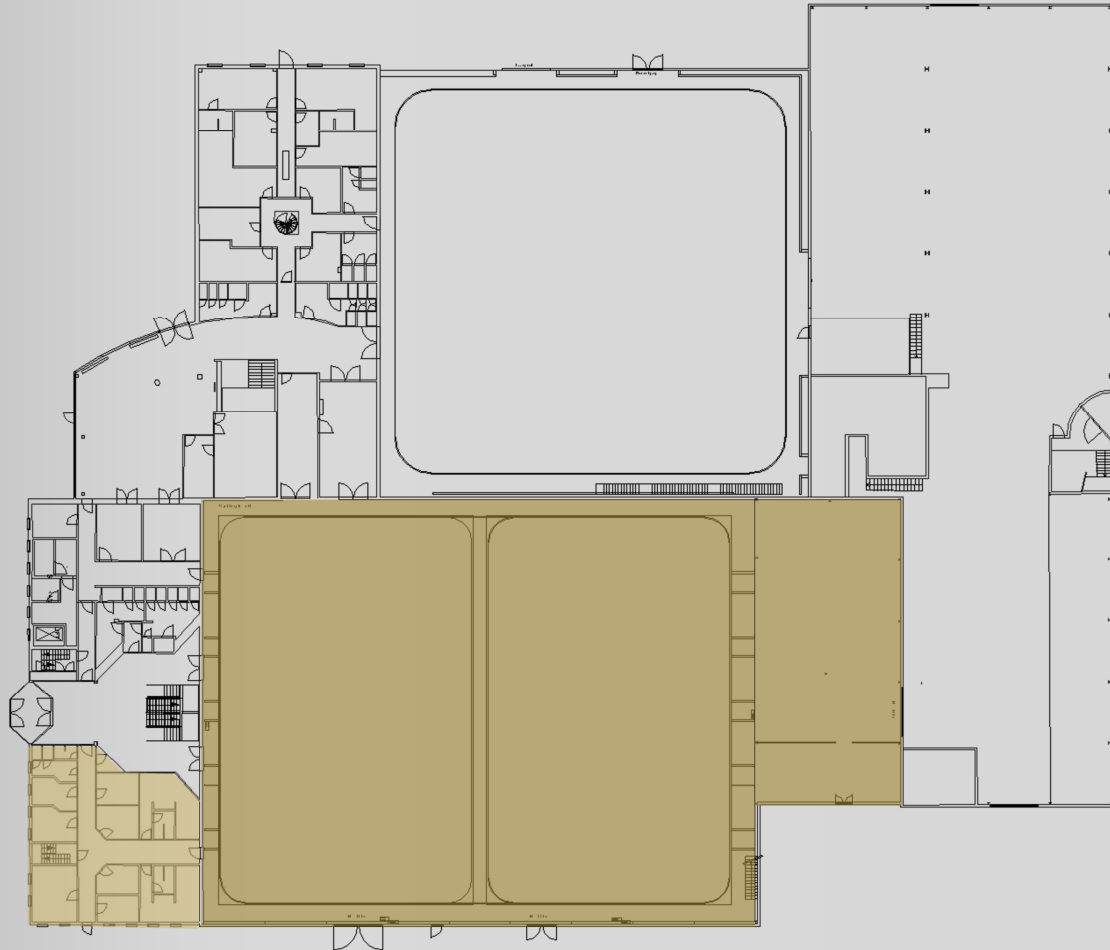

STUDIO FLOOR :

- Total floor area: 45,20m (L) x 34,60m (W) = 1564m²
 - Free floor area: 42,30m (L) x 31,70m (W) = 1341m² (inside cyclo)
 - Height under catwalks: 7,70m
 - Height under grid: 7,95m (max. height)
 - Rigging beams: 9,80m
 - Studio can be divided in 2 areas
- Floor type:
- Polybeton (Epoxy)

GRID:

- 3 grid frame with dimensions 19m x 9,60m
- 3 grid frame with dimensions 18m x 9,60m
- Each grid frame is equipped with 7 Harting 16 plugs with 5 channels, connected with Harting connectors in the dimmer room.

POWER SUPPLY:

Total of 600 kVA/ 3 x 380 + N, subdivided into:

Number - Amperes/phase - Connector - Location

- 1 x 250 A Powerlock Studio
- 1 x 125 A CEE Studio
- 1 x 63 A CEE Studio
- 2 x 4 32 A (25A) CEE Studio
- 4 x 250 A Powerlock Dimmer Room

ACCESS :

Emergency doors:

- 1 x 2,31m (W) Double emergency doors
- 1 x 1,92m (W) Double emergency doors
- 1 x 0,90m (W) Single emergency doors

Studio access:

- From storage to studio: 4 m (W) x 4,78 m (H)
- From street to studio: 4 m (W) x 4,78 m (H)
- From Studio to dressing rooms: 0,89 m (W) x 1,98m (H)
- Loading platform height relative to ground: 0 m

CURTAINS :

- Black: covers the entire studio
- Neutral light grey cyclorama: 60m
- Bluekey: 60m

the cyclorama system has 3 possible circuits on rails:

- the entire studio
- half the studio on the left
- half the studio on the right

All curtains are fireproof

BUILDING FACILITIES :

- Dressing rooms: 6 units (Average area 8 m²)
 - Mirror
 - Dresser
 - Chair
- Luxury dressing rooms : 2 units (20 m² + 5 m²)
 - Mirror
 - Dresser
 - Chair
 - Shower + washbasin
- Make-up room: 17 m²
 - Mirrors with lighting
 - Work surface
 - Washbasin with hot and cold water
- Production room